



WL3000 Medium Intensity Aviation Obstruction Light

Rev: 1.1V

Descriptions

WL3000 Medium intensity obstruction light (Type B / C) for marking Towers (Telecom, GSM), chimneys, buildings and any other potentially hazardous obstructions to air traffic with a steady burning red safety light. Compliant to ICAO standard, tested and approved by Intertek laboratory (a copy of the certificate is available upon request).

The enclosure of the WL3000 is made of die casting aluminum with powder coated finish, light weight, waterproof, shockproof and corrosion resistant with a polycarbonate dome.



Main functions and features

- Modular design and meets optics standard
- Tested and Certified to the ICAO Annex 14 standards by Intertek.
- 360° - Omni directional
- Based on LED technology
- Maintenance Free — Major Maintenance Cost Saving
- Resistant to Shock and Vibrations

- Corrosion Resistant Lamp& Housing
- Self-contained wiring compartment—eliminates additional boxes
- Several mounting holes are available on the light base
- Designed to mount onto existing bolt pattern installations
- Base material--Die casting aluminum LM6
- Outer sealing material—waterproof seal gasket
- Combustibility rating : UL94V0
- IP protection : IP65
- Operating temperature: -40° - +60°, can withstand the most severe environments
- Aviation red type
- Typical LED lifetime: ≥100, 000 hrs
- Power feeding part consists of two switching power supplies, which prolongs the power supply's life and makes the whole light more stability.

Specifications

- Operating voltage: AC85V ~ 265V

- Power consumption: 65W
- Steady burning (flashing optional)
- Intensity: 2,000cd \pm 15%
- Horizontal degree: 360°
- Vertical degree: 3°mm
- LED life: >100,000 hrs
- Operating temperature: -40° - +60°
- IP Protection: IP65
- Gross weight: 12Kg
- Dimension: 380mm(Dia.) * 335mm(H)

Installation

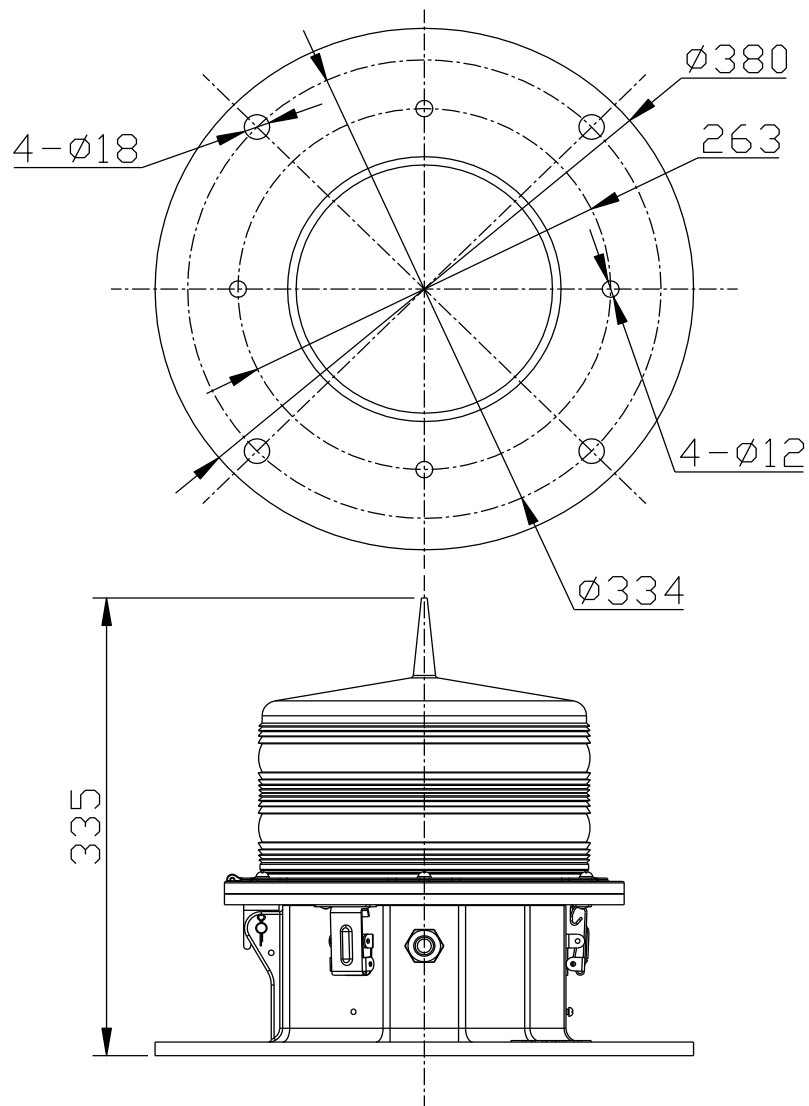

Wiring

- Secure the light on a smooth surface which has enough strength, if there is no mounting surface, we can customize special mounting bracket upon request.

- When installation, please stay away any nearby light source, at the same time, ensure that the photocell is not covered by any nearby object.
- Make sure the power supply can match the rated power of light before connecting.
- Unfasten three buckles on the base and overturn the lamp body, then the terminals are easily accessible.
- Insert the power cable from the cable gland and then connect them to the corresponding terminals inside the lamp body.

Wiring diagram

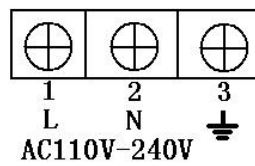

- After finishing the connection, return top array to close position & fasten the buckles.
- Check whether the power cables are connected correctly before power on.

Notice

- Check whether the power cables are connected correctly before power on
- Temperature rise inside the control box is normal phenomenon
- Please do not open any components inside by yourself
- This product is a sealed structure; Should not be tampered with by anyone other than registered installer

Delta Obstruction Lighting Ltd.
Delta House
Wrigley Street
Oldham
OL4 1SL
U.K
Tel:0044 (0) 161 7854940
Fax:0044 (0) 161 7854941